

## MJP 750 Series - Shaft Seal Mk4

### Assembly

Pos	Qty	Part No	Description
1	1	34037	<b>Shaft seal</b> (complete seal assy- to shaft diameter 130 mm )
2*			<b>Radial Seal</b>
	3	34039	(width 12 mm)
	3	34044	(width 15 mm)
3	1	WS-130	<b>Wear sleeve</b> (to shaft 133 mm )
4	2	32053	<b>O-ring</b>
5	1	50311	<b>Shaft seal hose</b>
6	4	HC - 168	<b>Hose Clamp</b> (to Shaft Seal Hose)
7	1	34061	<b>Shaft Seal Housing 750</b> (incl. bearing and lock ring 33103)
8	6	22000	<b>Lockwasher (set)</b>
9	6	21016	<b>Socket head screw</b>
10	1	23106	<b>Thordon Bearing</b>

## MJP 750 Series - Mk 1 Pump Unit Assembly

### Assembly

Pos	Qty	Part No	Description
2*	1	80255	<b>Impeller</b>
3	2	32070	<b>O-ring</b>
4	6	21016	<b>Socket head screw</b>
5	6	22000	<b>Lock washer</b>
6	1	24105	<b>Lock Ring</b>
7	1	32065	<b>O-ring</b>
8	1	32085	<b>O-ring</b>
9	24	21028 A	<b>Socket head screw</b>
10	24	22002	<b>Lock washer</b>
11	2	51011	<b>Lub oil pipe</b>
13	6	32059	<b>O-ring</b>
16*	1	32555	<b>Diffuser</b>
17	24	21052	<b>Hex head screw</b>
18	24	22002	<b>Lock washer</b>
19	1	32085	<b>O-ring</b>
20	1	32085	<b>O-ring</b>
21	12	21020	<b>Socket head screw</b>
22	11	22002	<b>Lock washer</b>
23	22	21015	<b>Hex head screw</b>
24	22	22002	<b>Lock washer</b>
25	1	32072	<b>O-ring</b>
		60010	<b>Assembly Kit 750 Mk1 - Seal exchange</b> (Needed bolts, washers and o-rings for reassembly after seal change)

# MJP 750 Series - Pump Unit Mk2

## Assembly

		Model	Manufactured
2*	1	80256	Impeller
3	2	32076	O-ring
4	6	21003	Socket head screw
5	6	22000	Lock washer
6	1	24106	Lockring
7	1	32065	O-ring
8	1	32085	O-ring
9	24	21069	Socket head screw
10	24	22002	Lock washer
11	2	51014	Lub oil pipe
12	2	32101	O-ring
13	6	32059	O-ring (3 pcs on each pipe)
14	2	21042	Hex head screw
15	2	22000	Lock washer
16*	1	32555	Diffuser
17	24	21052	Hex head screw
18	24	22002	Lock washer
19	1	32077	O-ring
20	1	32078	O-ring
21	12	21029	Socket head screw
22	12	22001	Lock washer
23	24	21052	Socket head screw
24	24	22002	Lock washer

60011 **Assembly Kit 750 Mk2 - Seal exchange**  
 (Needed bolts, washers and o-rings for reassembly after seal change)

# MJP 750 Series - Hub Unit Mk1

## Assembly

Pos	Qty	Part No	Description
1	1	44164	<b>Coupling</b>
2a, 3	1		<a href="#">Fits early model Disc Pack part no 42032:</a>
		21034B	<b>Coupling Bolts</b> (set of 8 pcs)
		23051	<b>Coupling Nuts</b> (set of 4 pcs)
2a, 3	1		<a href="#">Fits new model Disc Pack part no 42037:</a>
		21034C	<b>Coupling Bolts</b> (set of 8 pcs)
		23044	<b>Coupling Nuts</b> (set of 4 pcs)
4, 5	1		<b>Disc pack</b> (incl. bolts, nuts and washers)
		42032	early model
		42037	new model      available late 2005

<b>26</b>	<b>1</b>	<b>43166</b>	<b>Exchange Bearing Unit - tuned and ready for quick exchange - containing all parts from pos 6 to 21</b>
6	1	44204	<b>Flange</b>
7	8	21049	<b>Socket Head Screw</b>
8	8	22002	<b>Lock washer</b>
9	1	34002	<b>Mechanical Seal</b>
			New
			Refurbished (customer must return old seal)
10	1	44135	<b>Lid</b>
11	8	21016	<b>Socket Head Screw</b>
12	8	22000	<b>Lock washer</b>
13	1	32075	<b>O-ring</b>
14	1	32081	<b>O-ring</b>
15	1	44213	<b>Stub Shaft</b>
16	1	43121	<b>Conical Roller Bearing</b>
17	1	44175	<b>Bearing Housing</b>
18	2	33011	<b>Plug for disassemble</b>
19	1	43122	<b>Spherical Roller Bearing</b>
20	1	43176	<b>Support Washer</b>
21	1	23031	<b>Nut</b>

22	1	44105	<b>Cap</b>
23	8	21016	<b>Socket head screw</b>
24	8	22000	<b>Lock washer</b>
25	2	32067	<b>O-ring</b>

# MJP 750 Series - Hub Units

## Model      Manufactured

750 Mk1	1990 - 1999
750 Mk2	From 1999

## MJP 750 Series - Hub Unit Mk2 Assembly

### Coupling

Pos	Qty	Part No	Description
1	1	42028	Disc pack (incl. bolts, nuts and washers)
2	1	44165	Coupling
3	1	44152	Flanged shaft
4	1	22016	Coupling Washers (set of 8 pcs)
5	1	23052	Coupling Nuts (set of 8 pcs)
6	1	21072	Coupling Bolts (set of 8 pcs)
7	1	24106	Lock ring
8	1	32065	O-ring
9	6	21003	Socket head screw
10	6	22000	Lock washer
11	1	42178	Support Washer
12	1	23027	Nut KMT

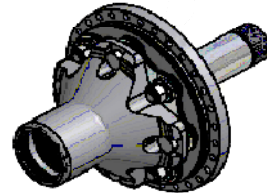

### Hub

Pos	Qty	Part No	Description
1	12	22000	Lock washer
2	1	44176	Bearing Housing
3	1	43121	Conical Roller Bearing
4	1	43122	Spherical Bearing
5	1	43120	OK Coupling
6	1	44136	Lid
7	12	21003	Screw
8	-	-	Seal Strip
9	-	-	Seat
10	1	33999	Mechanical Seal Housing
11	1	34004	Mechanical Seal New Refurbished (customer must return old seal)
12	4	21005	Hex head screw
13	1	43177	Support Washer
14	1	23031	Nut
15	1	32099	O-ring
16	1	43190	Spacer Ring
17	1	32047	O-ring
18	2	33011	Plug for disassemble



43167 Exchange Bearing Unit - tuned and ready for quick exchange  
- containing all parts from pos 1 to 18

## MJP 750 Series - Hub Units

Model	Manufactured
750 Mk1	1990 - 1999
750 Mk2	From 1999

## MJP 750 - Steering Unit Mk 4

### Assembly

Pos	Qty	Part No	Description	753-1002 A
1	2	-	Steering cylinder	
2	1	32552	Steering nozzle	
3	1	32550	Visor	
4	1	32553	Bucket	
5	2	32551	Link arm	(sold in pairs)
6	1	32554	Nozzle	
7	1	-	Cylinder bracket	
8	2	24057	Pin shaft	(steering nozzle)
9	2	24058	Pin shaft	(visor)
10	2	24059	Pin shaft	(bucket)
11	2	24060	Pin shaft	(link arm/visor)
11	2	24060	Pin shaft	(link arm/bucket)
12	2	35070	Bushing	(steering nozzle)
13	2	35072	Bushing	(bucket)
14	2	35071	Bushing	(visor)
15	4	35073	Bushing	(link arm)
16	1	-	Reversing cylinder	
17		37078	Bushing cylindr	
18	4	24061	Pin shaft	(reversing cyl.)
19	4	21068	Socket head screw	
20	4	22003	Lock washer	
21		24063	pin shaft	
22	4	24062	Pin shaft	(steering cyl.)
23	2	24039	Securing plate	(to be welded)
24	4	24248	Securing plate	(to be welded)
25	4	24246	Securing plate	(to be welded)
26	4	23078	Cotter pin	(reversing cyl.)

32322 Pin Shaft Set - 750 Mk4  
 32222 Bushing Set - 750 Mk4

## MJP 750 Series - Steering Unit Assembly

Model	Manufactured
Mk 1	1990 - 1992
Mk 2	1992 - 1993
Mk 3	1993 - 2000
Mk 4	2000 -
-	Prices for 750 Mk 1 - Mk 3 on request
-	Old models can be upgraded with newer steering parts. Contact MJP for information.

## Hydraulic Hose Arrangement

### MJP 750 Series - All Steering Units

Pos	Qty	Part No	Description		
1	4	51204	Bonded seal	3/4"	
2	8	51203	Bonded seal	1/2"	
3	4	51205	Bonded seal	3/8"	
4	2	51358-B	Hydraulic Hose 3/4" (Reversing Cyl.)	0°-45°	L=850
5	2	51356-A	Hydraulic Hose 1/2" (Steering Cyl.)	0° - 90°	L=450
6	2	51356-A	Hydraulic Hose 1/2" (Steering Cyl.)	0° - 90°	L=400
7	2	51353-B	Protection Hose 3/8" (Steering Cyl.)	open - 90°	L=2000
8	2	51353-B	Protection Hose 3/8" (Reversing Cyl.)	open - 90°	L=2000
9	1+1	52017	Hydraulic connection block 1/2"		
10	1	52019	Hydraulic connection block 3/4"		

#### NOTE

Above is standard.

Different lengths may exist - always measure length to avoid faulty purchase orders

See reference page.

## MJP 750 Series - Hydraulic Hose Arrangement

### Model      Manufactured

750 Mk1      1990 - 1999