

MJP 850 Series - Shaft Seal Mk2

Assembly

Pos	Qty	Part No	Description
1	-	-	Quoted

MJP 850 Series - Pump Unit Mk2

Assembly

Pos	Qty	Part No	Description
2*	1	80258	Impeller
3	2	32076	O-ring
4	6	21003	Socket head screw
5	6	22000	Lock washer
6	1	24106	Lockring
7	1	32065	O-ring
8	1	32085	O-ring
9	24	21069	Socket head screw
10	24	22002	Lock washer
11	2	51012	Lub oil pipe
12	2	32101	O-ring (1 pc on each pipe)
13	6	32059	O-ring (3 pcs on each pipe)
14	2	21042	Hex head screw
15	2	22000	Lock washer
16*	1	32565	Diffuser
17	24	21026	Hex head screw
18	24	22002	Lock washer
19	1	32077	O-ring
20	1	32078	O-ring
21	12	21029	Socket head screw
22	12	22001	Lock washer
23	24	21052	Socket head screw
24	24	22002	Lock washer

60013 Assembly Kit 850 Mk2 - Seal exchange
(Needed bolts, washers and o-rings for reassembly after seal change)

MJP 850 Series - Hub Unit Mk2 Assembly

Coupling

Pos	Qty	Part No	Description
1	1	42033	Disc pack (incl. bolts, nuts and washers)
2	1	44166	Coupling
3	1	44153	Flanged shaft (24 bolt - low power)
4	8	22032	Lock washer
5	1	23056	Coupling Nuts (set of 8 pcs)
6	1	21103	Coupling Bolts (set of 8 pcs)
7	1	24100	Lock ring
8	1	32065	O-ring
9	6	21043	Socket head screw
10	6	22000	Lock washer
11	1	43180	Support Washer
12	1	23027	Nut KMT

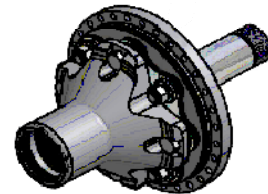

Hub

Pos	Qty	Part No	Description
1	12	22000	Lock washer
2	1	44177	Bearing Housing
3	1	43123	Conical Roller Bearing
4	1	43122	Spherical Bearing
5	1	43125	OK Coupling
6	1	44137	Lid
7	12	21024	Socket head screw
8	1	-	
9	1	-	
10	1	33995	Mechanical Seal Housing
11	1		Mechanical Seal
		34011	New
		34011 R	Refurbished (customer must return old seal)
13	1	43179	Support Washer
14	1	23031	Nut
15	1	32047	O-ring
16	1	43191	Spacer Ring
17	1	32099	O-ring
18	2	33011	Plug for disassemble



43168 [Exchange Bearing Unit - tuned and ready for quick exchange](#)
- containing all parts from pos 1 to 18

MJP 850 Series - Hub Units

Model	Manufactured	Description
850 Mk1	1986-2004	Licensed to Niigata Japan
850 Mk2	2004-	

MJP 850 - Steering Unit Mk 2

Assembly

Pos	Qty	Part No	Description
1	2	41738	Steering Cylinder
2	1	32562	Steering nozzle
3	1	32540	Visor
4	1	32563	Bucket
5	2	32561	Link arm (sold in pairs)
6	1	32564	Nozzle
7	2	-	Cylinder Bracket
8	2	24130	Pin shaft (steering nozzle)
9	2	24131	Pin shaft (visor)
10	2	24132	Pin shaft (bucket)
11	4	24133	Pin shaft (link arm)
12	2	35075	Bushing (split) (steering nozzle)
13	2	35076	Bushing (bucket)
14	2	35076	Bushing (visor)
15	4	35077	Bushing (link arm)
16	1	41737	Reversing cylinder
17	2	35078	Bushing (cylinder)
18	4	24134	Pin shaft (reversing cyl.)
19	4	21068	Socket head screw
20	4	22003	Lock washer
21	2	24063	Pin shaft
22	2	24062	Pin shaft (steering cyl.)
23	2	33110	Clamp (to be welded)
24	4	33109	Clamp (to be welded)
25	4	33108	Clamp (to be welded)
26	2	23080	Cotter pin (reversing cyl.)

32324 Pin Shaft Set - 850 Mk2
 32224 Bushing Set - 850 Mk2

MJP 850 Series - Steering Unit Assembly

Model	Manufactured	Description
Mk 1	1986 - 2004	
Mk 2	2004 -	